



September 6, 2024

To learn more about Frost Creek real estate, please contact the sales office at 970.455.3072.

KAKIE HOLLAND
 Director of Sales, GRI, CNE
 970.319.5585 - Mobile
 kholland@frostcreek.com

LYNNE SANDOVAL
 Sales Executive
 303.551.2689 - Mobile
 lsandoval@frostcreek.com

FROST CREEK MEMBER CABINS AND YURTS

1 Bluebells	9 Gray Rock
2 Buttercup	10 Brook
3 Columbine	11 Brown
4 Larkspur	12 Cutthroat
5 Primrose	13 Rainbow
6 Sage	14 Aspen (Yurt)
7 Shooting Star	15 Cottonwood (Yurt)
8 Yarrow	



Pricing and availability is subject to change without notice. Homesite acreage is approximate.

HUNTER'S View

GATE-HOUSE

NATURE PARK

Original Wilber E. Frost Cabin

MAIN ENTRANCE

SITE PLAN

ARTIST RENDERING

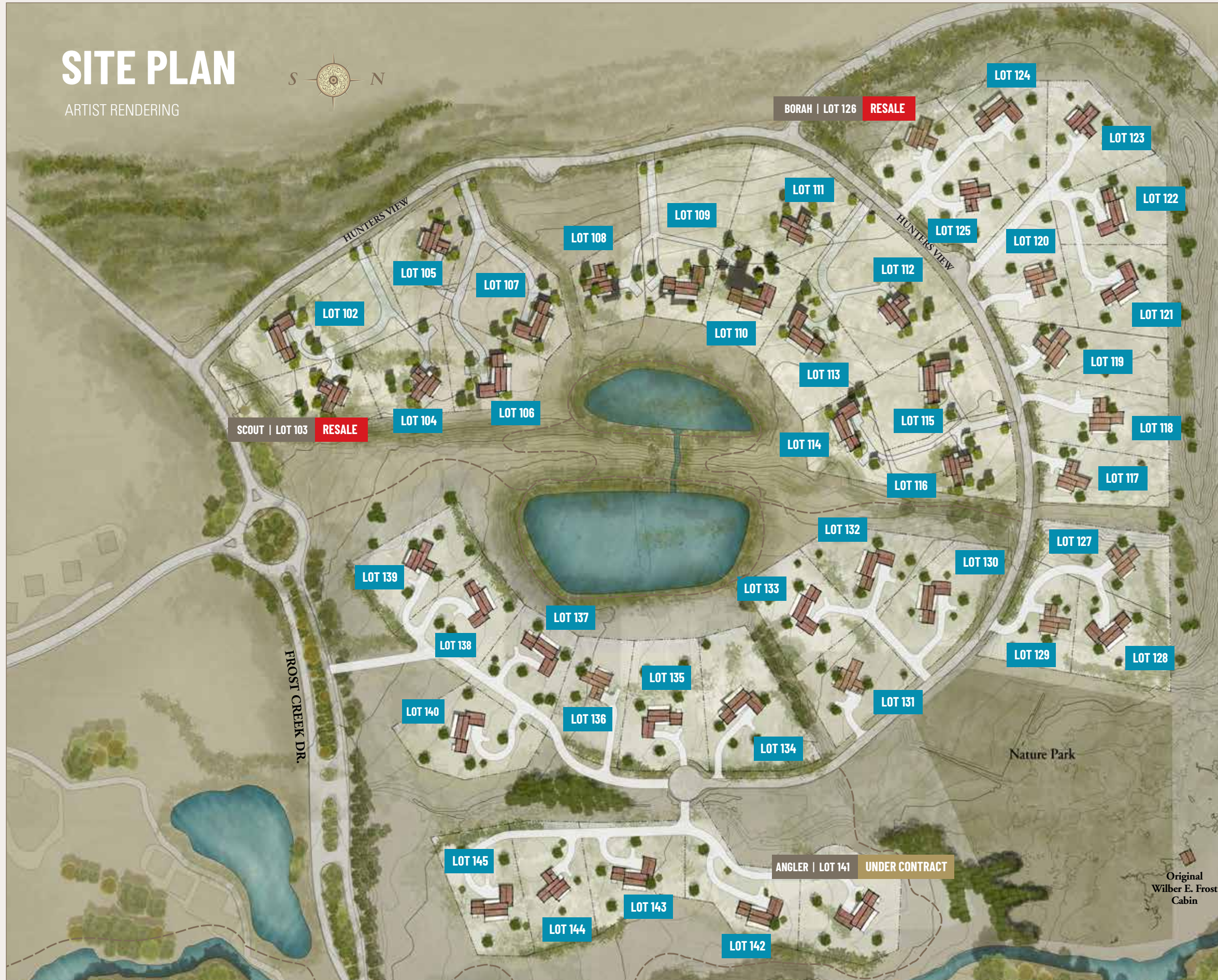

HUNTER'S *View*

FEATURED HOME



Developer Owned

ANGLER 2,874 SF / 4 Bed / 4.5 Bath
Lot 141/591 Hunters View Ln. UNDER CONTRACT



TO LEARN MORE ABOUT HUNTER'S VIEW, PLEASE CONTACT THE SALES OFFICE AT 970.455.3072.

KATHERINE "KAKIE" HOLLAND
Director of Sales, GRI, CNE
970.319.5585 - Mobile
kholland@frostcreek.com

LYNNE SANDOVAL
Sales Executive
303.551.2689 - Mobile
lsandoval@frostcreek.com

1094 Frost Creek Dr., Eagle, CO 81631

Mailing: PO Box 659, Eagle, Colorado 81631

www.frostcreek.com/huntersview