



October 30, 2024

To learn more about Frost Creek real estate, please contact the sales office at 970.455.3072.

LYNNE SANDOVAL  
 Director of Sales  
 303.551.2689 - Mobile  
 lsandoval@frostcreek.com

### FROST CREEK MEMBER CABINS AND YURTS

|             |                      |
|-------------|----------------------|
| 1 Bluebells | 7 Shooting Star      |
| 2 Buttercup | 8 Yarrow             |
| 3 Columbine | 9 Brook              |
| 4 Larkspur  | 10 Cutthroat         |
| 5 Primrose  | 11 Aspen (Yurt)      |
| 6 Sage      | 12 Cottonwood (Yurt) |



Pricing and availability is subject to change without notice. Homesite acreage is approximate.

### LEGEND

|  |  |                    |  |                |
|--|--|--------------------|--|----------------|
|  |  | AVAILABLE          |  | UNDER CONTRACT |
|  |  | SOLD               |  | FUTURE RELEASE |
|  |  | UNDER CONSTRUCTION |  |                |

To Eagle Main St. 7.9 Miles

To Sylvan Lake 8.6 Miles



# SITE PLAN

ARTIST RENDERING

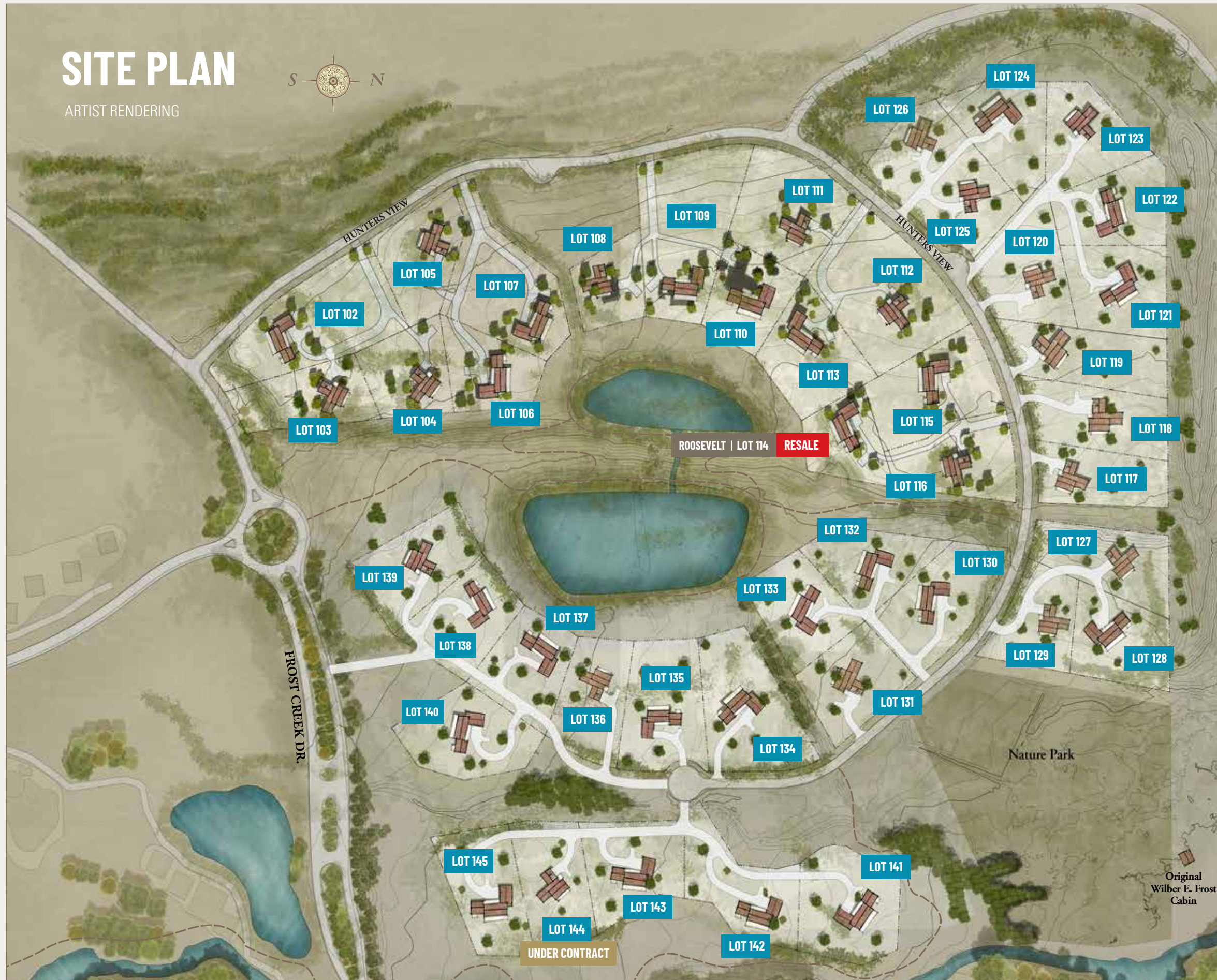

# HUNTER'S *View*

## FEATURED HOME



**ROOSEVELT** 2,874 SF / 4 Bed / 3.5 Bath  
Lot 114 / 434 Hunters View Ln. \$2,695,000



TO LEARN MORE ABOUT HUNTER'S  
VIEW, PLEASE CONTACT THE SALES  
OFFICE AT 970.455.3072.

**LYNNE SANDOVAL**  
Director of Sales  
303.551.2689 - Mobile  
lsandoval@frostcreek.com

1094 Frost Creek Dr., Eagle, CO 81631

Mailing: PO Box 659, Eagle,  
Colorado 81631

[www.frostcreek.com/huntersview](http://www.frostcreek.com/huntersview)