



November 16, 2024

To learn more about Frost Creek real estate, please contact the sales office at 970.455.3072.

LYNNE SANDOVAL
 Director of Sales
 303.551.2689 - Mobile
 lsandoval@frostcreek.com

FROST CREEK MEMBER CABINS AND YURTS

1 Bluebells	7 Shooting Star
2 Buttercup	8 Yarrow
3 Columbine	9 Brook
4 Larkspur	10 Cutthroat
5 Primrose	11 Aspen (Yurt)
6 Sage	12 Cottonwood (Yurt)



114
2,874 SF
\$2,695M
RESALE

10
4.465
\$875K
RESALE

6
3.67
\$1,099M
RESALE

35
5.4
\$1.05M
RESALE

87
1.136
\$775K

86
1.27
\$775K

83
1.348
\$900K

17
3.99
\$875K
RESALE

55
6.89
UC
RESALE

SITE PLAN

ARTIST RENDERING

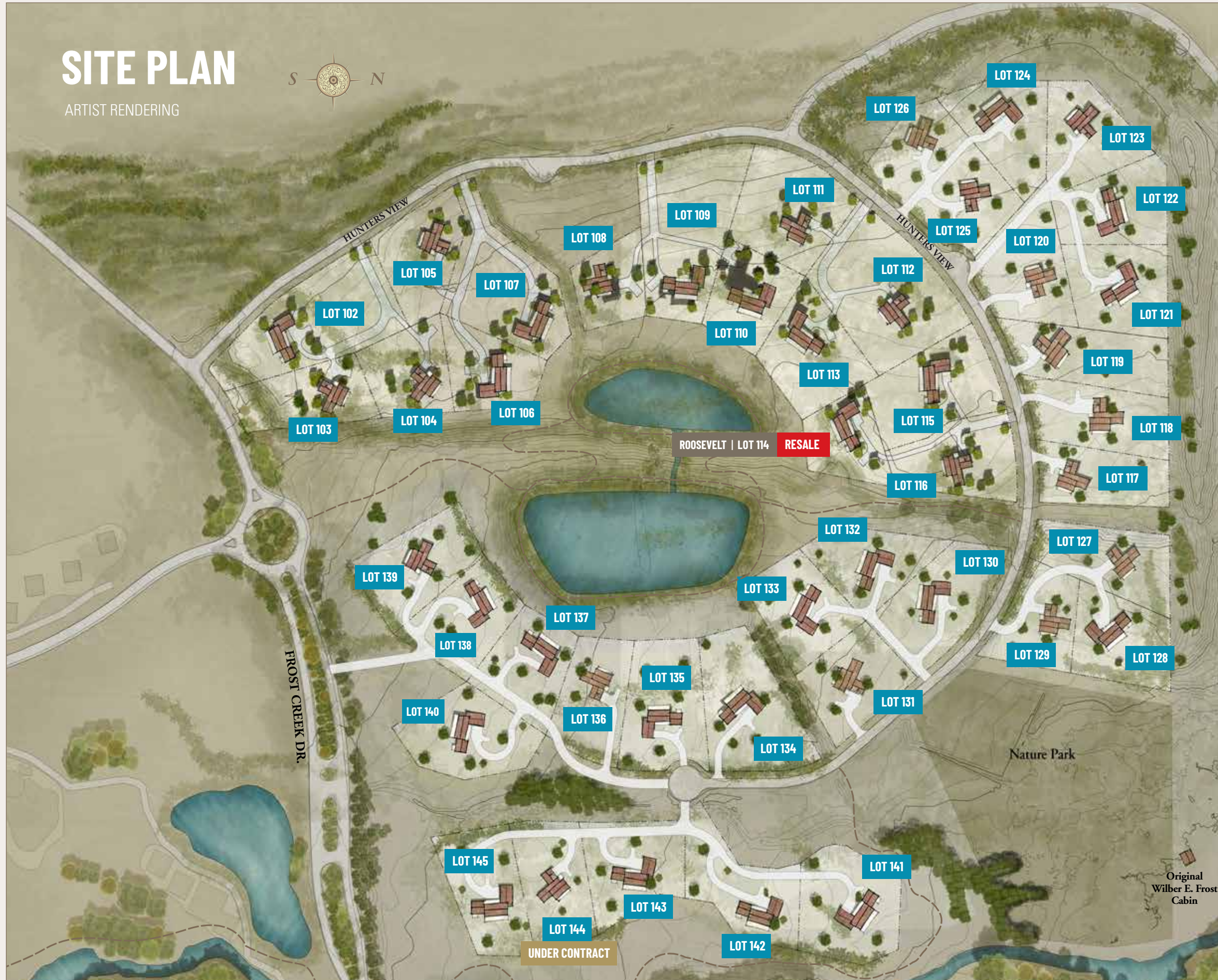

HUNTER'S *View*

FEATURED HOME



ROOSEVELT 2,874 SF / 4 Bed / 3.5 Bath
Lot 114 / 434 Hunters View Ln. \$2,695,000



TO LEARN MORE ABOUT HUNTER'S
VIEW, PLEASE CONTACT THE SALES
OFFICE AT 970.455.3072.

LYNNE SANDOVAL
Director of Sales
303.551.2689 - Mobile
lsandoval@frostcreek.com

1094 Frost Creek Dr., Eagle, CO 81631

Mailing: PO Box 659, Eagle,
Colorado 81631

www.frostcreek.com/huntersview