



May 1, 2025

To learn more about Frost Creek real estate, please contact the sales office at 970.455.3072.

LYNNE SANDOVAL
Director of Sales
303.551.2689 - Mobile
lsandoval@frostcreek.com

FROST CREEK

MEMBER CABINS AND YURTS

1 Bluebells	7 Shooting Star
2 Buttercup	8 Yarrow
3 Columbine	9 Brook
4 Larkspur	10 Cutthroat
5 Primrose	11 Aspen (Yurt)
6 Sage	12 Cottonwood (Yurt)



Pricing and availability is subject to change without notice. Homesite acreage is approximate.

LEGEND

- ▲ AVAILABLE
- UNDER CONTRACT
- ▲ SOLD
- FUTURE RELEASE
- ▲ UNDER CONSTRUCTION

SITE PLAN

ARTIST RENDERING

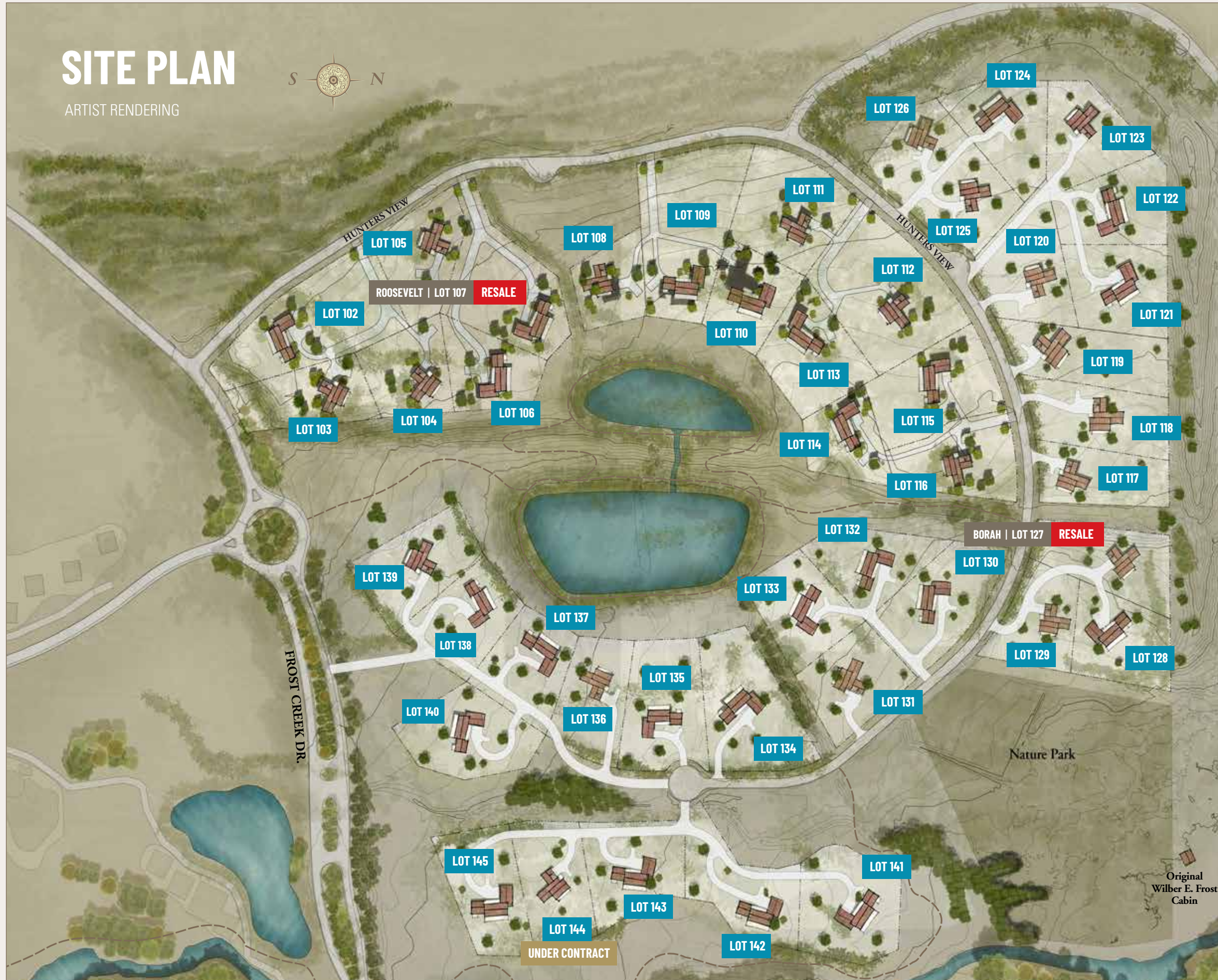

HUNTER'S *View*

FEATURED HOME



ROOSEVELT 2,874 SF / 4 Bed / 3.5 Bath
Lot 107 / 140 Hunters View Ln. \$2,850,000



BORAH 2,651 SF / 4 Bed / 3.5 Bath
Lot 127 / 481 Hunters View Ln. \$2,450,000



TO LEARN MORE ABOUT HUNTER'S VIEW, PLEASE CONTACT THE SALES OFFICE AT 970.455.3072.

LYNNE SANDOVAL
Director of Sales
303.551.2689 - Mobile
lsandoval@frostcreek.com

1094 Frost Creek Dr., Eagle, CO 81631

Mailing: PO Box 659, Eagle, Colorado 81631

www.frostcreek.com/huntersview